

Coupe sur passage

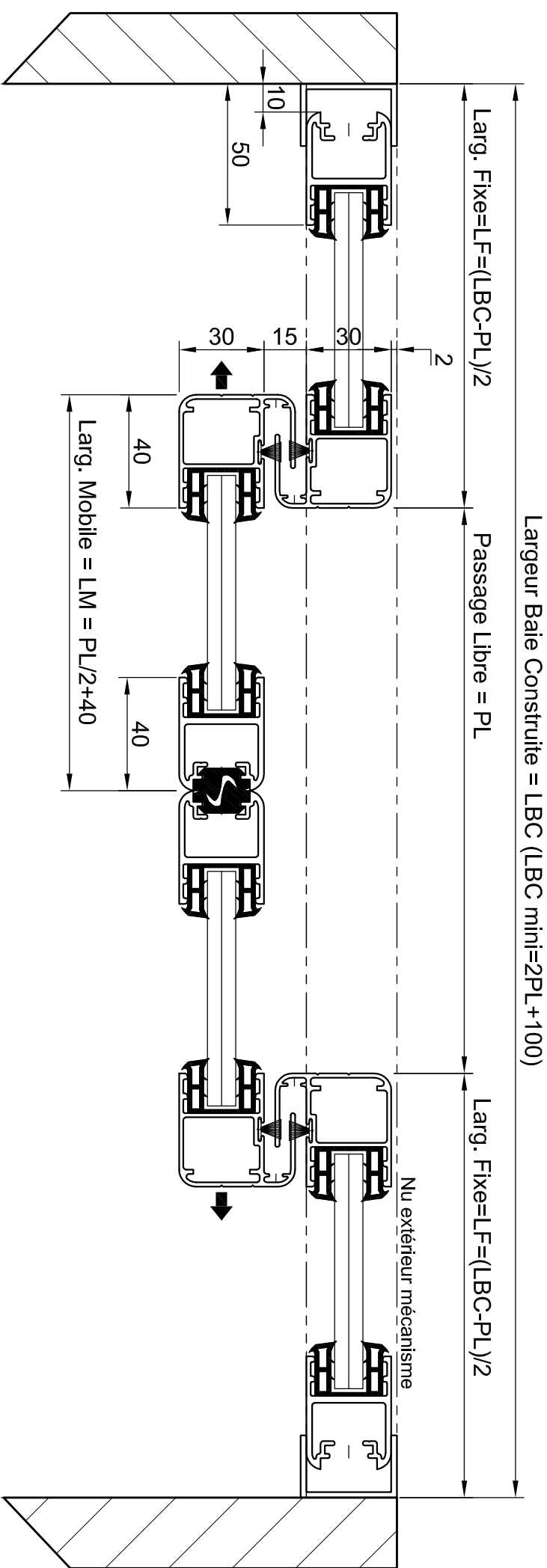
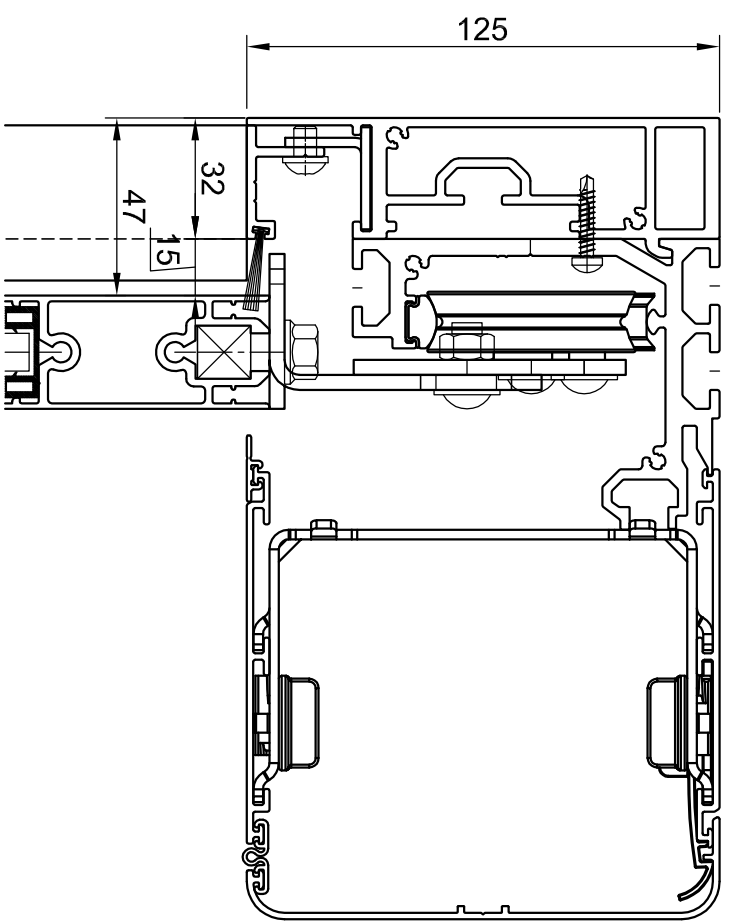
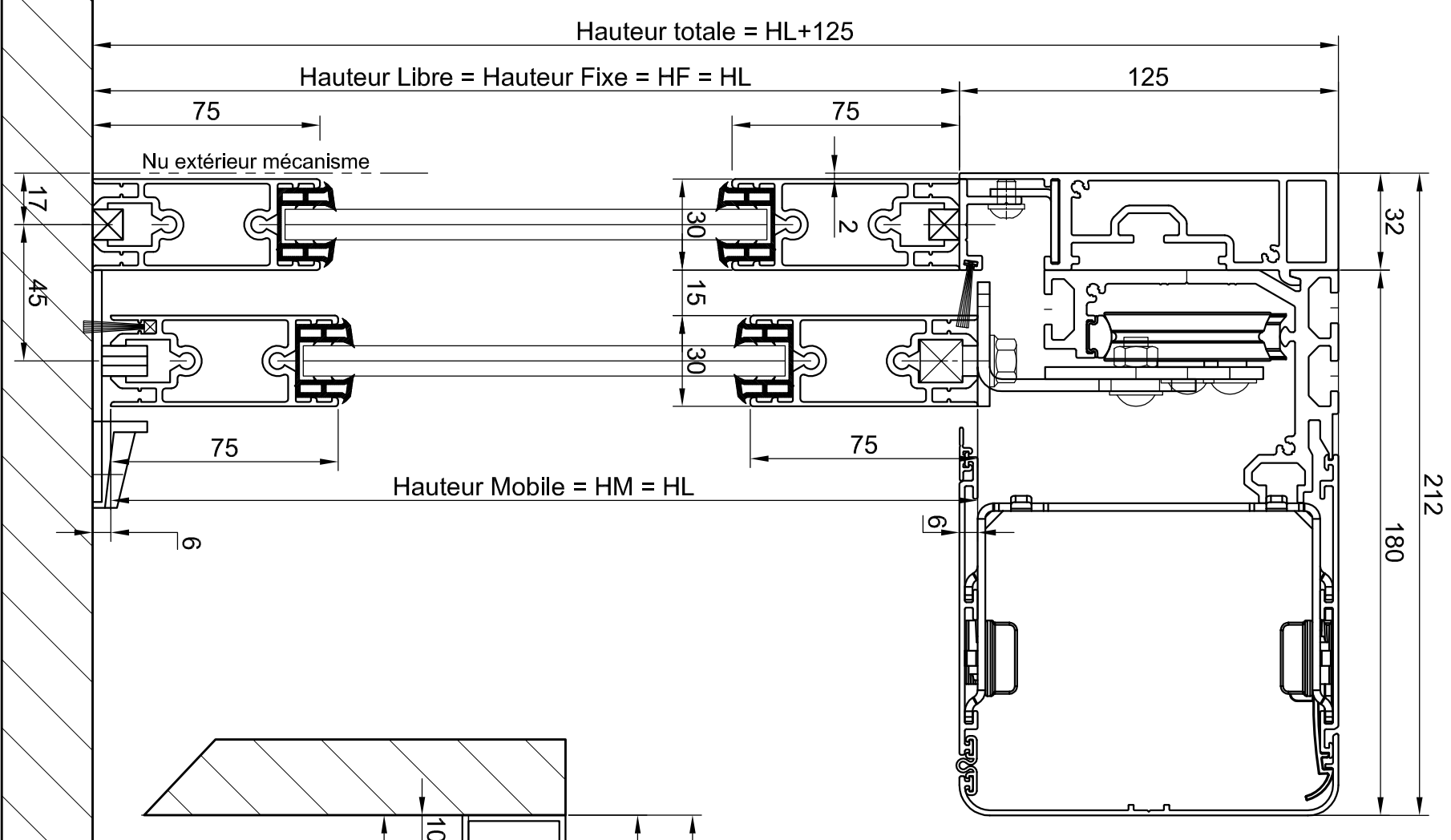

Dimensions Vitrage  
 Fixe: (LF-67) x (HL-119)  
 Vantail: (PL/2-17) x (HL-123)  
 8mm < Epaisseur < 23mm

**manusa**  
 Tél: 0479351500  
 Fax: 0479615050  
 Format: A3 Ech: Date: 01/10/2013

**manusa**  
 VISIO - 130 - Raidisseur 32  
 PA 2 Vantaux Couissants + Fixes  
 Réf: PTV3032-Raid32-2VC+2F 130  
 Ind: